

1 FOURTH FLOOR PLAN  
SCALE: 1/4" = 1'-0"

**GENERAL NOTES**

- ALL ROOMS IN THE PROJECT AREA TO BE REFURBISHED INCLUDING CLEANING, PAINTING, PATCHING RE-LAMPING OF LIGHT FIXTURES AND INSTALLATION OF NEW CARPETING AND NEW BASE.
- ADDITIONAL SCOPE AS FOLLOWS:
  - 434, 434A - RENOVATE AS MULTI-PURPOSE CONFERENCE ROOM WITH NEW CEILING, MEDIA AV UPGRADE, RELOCATED OUTLETS AND NEW FURNISHINGS
  - 437 - PROVIDE ONE NEW WORKSTATION AND NEW DUAL-CHANNEL WIREMOLD AT 4 NOTED WORKSTATIONS
  - 437A - RENOVATE AS COMPUTATIONAL RESEARCH LAB WITH NEW WORKSTATIONS, AND NEW DUAL CHANNEL WIREMOLD
  - 437B - RENOVATE AS COMPUTATIONAL RESEARCH LAB WITH NEW LIGHTING, NEW WORKSTATIONS AND NEW DUAL-CHANNEL WIREMOLD
  - 437C - RENOVATE AS COMPUTATIONAL RESEARCH LAB WITH NEW LIGHTING, NEW WORKSTATIONS AND DUAL-CHANNEL WIREMOLD
- PROVIDE COVER PLATES FOR ALL DEFUNCT OUTLETS
- IT IS INTENDED THAT ALL POWERSTRUT, SHELVING AND BRACKETS REQUIRED FOR USE IN THIS PROJECT WILL BE SALVAGED FROM THE EXISTING ROOMS OR COME FROM ATTIC STOCK ALL WORK STATIONS WILL HAVE TWO SHELVES.
- SEE INTERIOR ELEVATIONS FOR LOCATIONS OF POWERSTRUT TO BE REMOVED, RELOCATED OR REMAIN IN PLACE.

**KEYED NOTES**

- NEW WORK STATION WITH NEW DUAL-CHANNEL WIREMOLD
- EXISTING WORK STATION WITH NEW DUAL-CHANNEL WIREMOLD
- EXISTING COAT RACK TO REMAIN
- NEW 48" WIDE X 48" LONG WHITE BOARD, TOP AT 6'-6" AFF UNLESS INDICATED OTHERWISE. HARDWOOD FRAME TO MATCH EXISTING FRAMES
- REPAIR EDGE-BANDING AT EXISTING PLASTIC LAMINATE BENCH TOP
- EXISTING TACK BOARD TO REMAIN
- NEW 48" WIDE X 48" LONG TACK BOARD, TOP AT 6'-6" AFF UNLESS INDICATED OTHERWISE. HARDWOOD FRAME TO MATCH EXISTING FRAMES
- NEW 40" WIDE X 48" LONG WHITE BOARD, FRAME TO MATCH TACK BOARD ON OPPOSITE WALL. TOP OF NEW WHITE BOARD EQUALS 6'-4" AFF TO MATCH TACK BOARD
- NEW TRASH/RECYCLING BINS BY OWNER
- NEW COAT HOOKS TO MATCH EXISTING
- NEW BUILDING STANDARD BUILT-IN BENCH
- NEW WHITE BOARD. SEE INTERIOR ELEVATION FOR SIZE

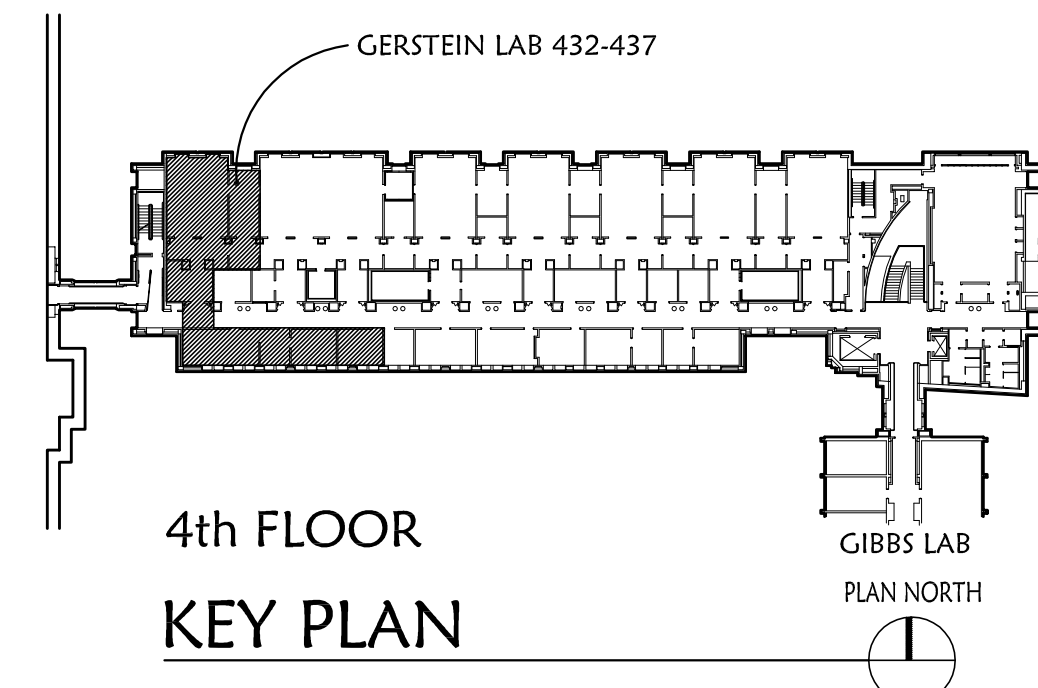

4th FLOOR  
KEY PLAN

Yale University

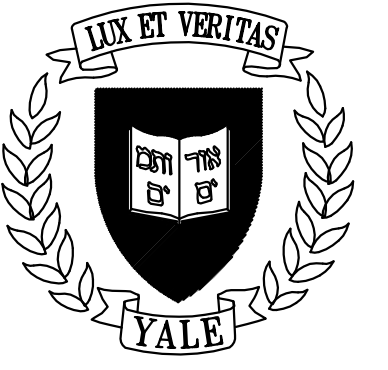

Central Campus

Office of Facilities  
2 Whitney Avenue  
New Haven, CT 06520

DAVID THOMPSON ARCHITECTS LLC  
1211 Chapel Street  
New Haven, Connecticut 06511  
P: (203) 624-4266  
F: (203) 624-3566

W S P  
MECHANICAL ELECTRICAL PLUMBING ENGINEERS  
88 Black Falcon Avenue, Suite 210  
Boston, Massachusetts 02210  
P: (617) 210-1800  
F: (617) 210-1800

NO.	DATE	DESCRIPTION
		FOR CONSTRUCTION SET
		PERMIT SET
	1/5/15	BID SET
	11/12/14	PRELIMINARY DESIGN

PROJECT NAME	BASS 432 - 434, 437 LAB RENOVATION
BUILDING NAME & ADDRESS	BASS CENTER 256 WHITNEY AVENUE NEW HAVEN, CONNECTICUT
YALE PROJECT NUMBER	14061704

DRAWING TITLE  
**FOURTH FLOOR PLAN**

SCALE	1/4" = 1'-0"	DTA
CAD FILENAME		1/5/15

DRAWING NUMBER  
**A1.1**